

# HOOK

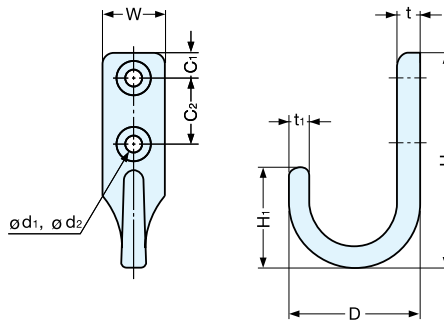

# EL-25, 30



Material	Finish
304 Stainless Steel	Mirror

Item No.	D	H	H <sub>1</sub>	t	t <sub>1</sub>	W	C <sub>1</sub>	C <sub>2</sub>	d <sub>1</sub>	d <sub>2</sub>	Load Capacity (kg)	Weight (g)	Box (pcs)	Carton (pcs)	Screw
EL-25	26 ( 1-1/32" )	40 ( 1-37/64" )	19	5.5	4	12	5	12	3	6	20 ( 44 lbs )	19	30	300	2.7 × 16
EL-30	32 ( 1-17/64" )	54.5 ( 2-9/64" )	25	6.0	5	15	6	16	4	8		32	20	200	3.8 × 20

# HOOK



# EP-25, 40

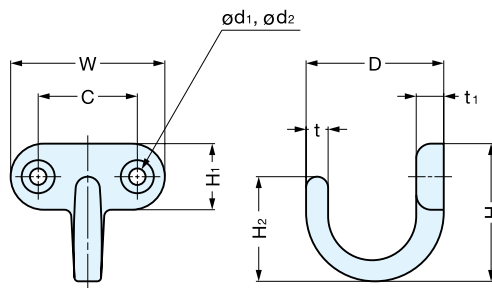

Material	Finish
304 Stainless Steel	Mirror

Item No.	D	W	H	H <sub>1</sub>	H <sub>2</sub>	t	t <sub>1</sub>	C	d <sub>1</sub>	d <sub>2</sub>	Load Capacity (kg)	Weight (g)	Box (pcs)	Carton (pcs)	Screw
EP-25	25 ( 63/64" )	28	25 ( 63/64" )	12	19	4	5	18	3	6	20 ( 44 lbs )	16	30	300	2.7 × 16
EP-40	32 ( 1-17/64" )	36	33 ( 1-19/64" )	16	25	5	6	23	4	8		31	20	200	3.8 × 20

# HOOK



# FC-50, 65

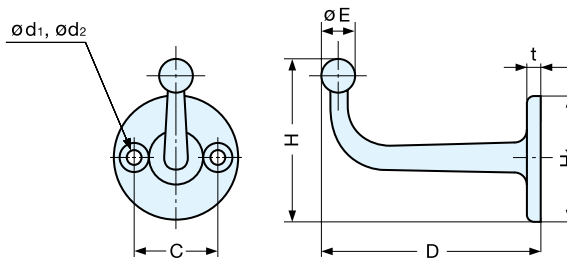

Material	Finish
304 Stainless Steel	Mirror

Item No.	D	H	H <sub>1</sub>	t	C	d <sub>1</sub>	d <sub>2</sub>	E	Load Capacity (kg)	Weight (g)	Box (pcs)	Carton (pcs)	Screw
FC-50	47 ( 1-27/32" )	37 ( 1-29/64" )	28	3	18.5	3.3	6.5	6.5	10(22 lbs)	25.0	40	480	3.1 × 16
FC-65	65 ( 2-9/16" )	44 ( 1-47/64" )	35	4	22.5	4.2	8.0	8.0	12(26 lbs)	54.5	20	240	3.8 × 20